



# COLLETTORI CON VALVOLE A SFERA MANIFOLDS WITH BALL VALVES

## Serie NINO Pex

### Descrizione / Description

Collettori "NINO" con attacchi per tubo Pex e valvola a sfera.

Manifold "NINO" with connections for Pex pipe and ball valve.

### Funzione / Function

I collettori di distribuzione "NINO" sono generalmente utilizzati nelle reti di distribuzione di acqua calda e fredda. Grazie alla loro configurazione permettono l'alimentazione in parallelo delle utenze per acqua calda e/o fredda riducendo al minimo le perdite di carico. I collettori sono prodotti in conformità alle normative in materia e sono certificati relativamente alla composizione chimica dei materiali impiegati ed a livello dimensionale.

The distribution manifolds "NINO" are typically used for hot and cold water distribution. Due to the configuration they may be used to distribute cold/hot water in parallel reducing at minimum the pressure drop. The manifolds are produced according to the relevant rules and are certified for material chemical composition and dimensional request.

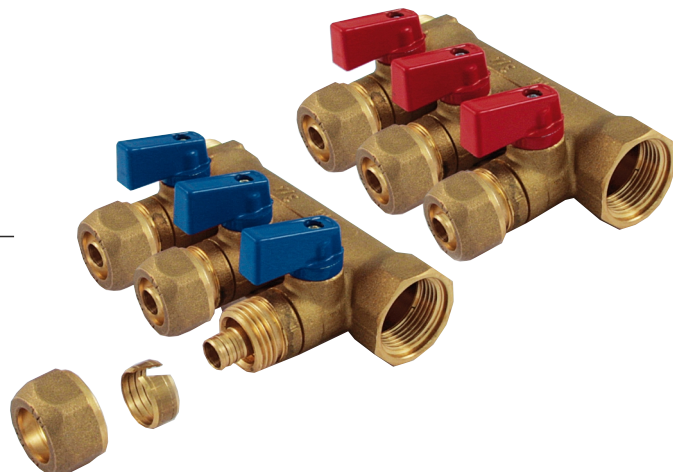

### Caratteristiche Tecniche

Temperatura max di esercizio: 110°C  
 Temperatura min di esercizio: -20°C  
 Pressione max di esercizio: 16 bar  
 Filettature : maschio UNI ISO 7/1 R conica  
 femmina UNI ISO 7/1 Rp cilindrica

### Technical Features

Maximum temperature: 110°C  
 Minimum temperature: -20°C  
 Maximum operating pressure: 16 bar  
 Threads: male UNI ISO 7/1 R conical  
 female UNI ISO 7/1 Rp parallel

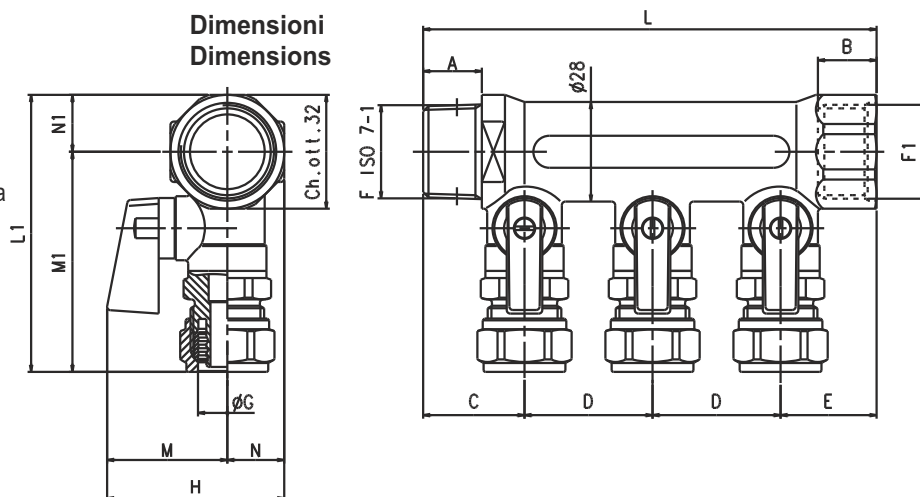

Codice/Code	Size	A	B	C	D	E	F	F1	G	H	L	L1	M	M1	N	N1
182 0050/182 0051	3/4"	16,5	16,5	28,5	36,0	27,0	3/4"	3/4"	16X2,0	51,0	91,5	78,0	35,0	62,0	16,0	16,0
182 0052/182 0053	3/4"	16,5	16,5	28,5	36,0	27,0	3/4"	3/4"	16X2,0	51,0	127,5	78,0	35,0	62,0	16,0	16,0
182 0054/182 0055	3/4"	16,5	16,5	28,5	36,0	27,0	3/4"	3/4"	16X2,0	51,0	163,5	78,0	35,0	62,0	16,0	16,0
182 0056/182 0057	3/4"	16,5	16,5	28,5	36,0	27,0	3/4"	3/4"	16X2,2	51,0	91,5	78,0	35,0	62,0	16,0	16,0
182 0058/182 0059	3/4"	16,5	16,5	28,5	36,0	27,0	3/4"	3/4"	16X2,2	51,0	127,5	78,0	35,0	62,0	16,0	16,0
182 0060/182 0061	1"	17,0	17,0	29,0	36,0	27,0	1"	1"	16X2,2	54,0	92,0	72,5	35,0	53,5	19,0	19,0
182 0062/182 0063	1"	17,0	17,0	29,0	36,0	27,0	1"	1"	16X2,2	54,0	128	72,5	35,0	53,5	19,0	19,0

Descrizione	Materiale	Trattamento	Description	Material	Treatment
Corpo	Ottone CW617N - EN12165	-	Body	CW617N-EN12165 brass	-
Sfera	Ottone CW617N - EN12164	Cromata	Ball	CW617N-EN12164 brass	Chrome plated
Stelo	Ottone CW617N - EN12164	-	Stem	CW617N-EN12164 brass	-
O-rings	Gomma nitrilica NBR	-	O-rings	Nitrile Rubber NBR	-
Guarnizioni laterali	P.T.F.E.	-	Side washers	P.T.F.E.	-
Leva	Alluminio	Verniciata rossa o blu	Handle	Aluminium	Painted red or blue
Vite	Acciaio	-	Screw	Steel	-
Ogiva	Ottone CW508L - EN12449	-	Ring	CW508L-EN12449 brass	-
Dado	Ottone CW617N - EN12165	-	Nut	CW617N-EN12165 brass	-

### Certificazioni Certifications





## Guida alle connessioni Fitting guide

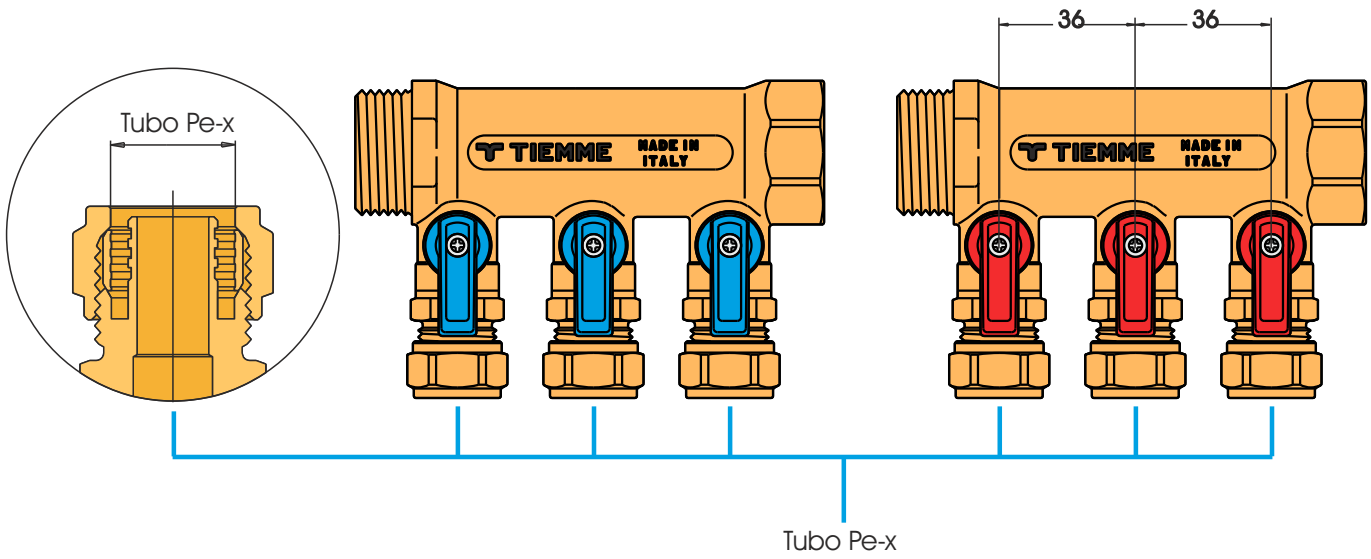

## Cassette utilizzabili Boxes used

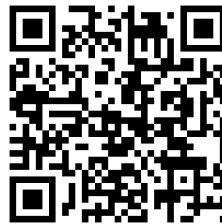
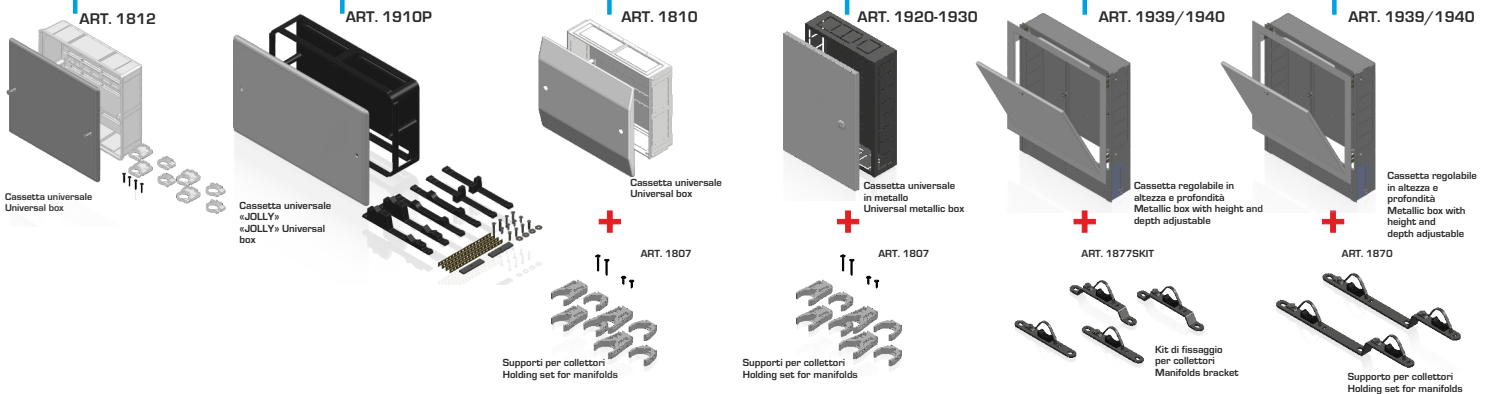
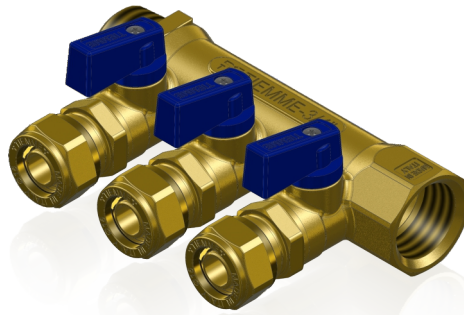

**TIEMME Raccorderie S.p.A.**  
Via Cavallera 6/A (Loc. Barco) - 25045 Castegnato (Bs) - Italy  
Tel +39 030 2142211 R.A. - Fax +39 030 2142206  
info@tiemme.com - www.tiemme.com